

AEROSPACE TECHNICAL DATA

**TECHNICAL
MANUALS
ENGINEERING
DRAWINGS
ON
MILITARY &
COMMERCIAL AIRCRAFT**



**ONLINE
TECHNICAL
DATA
SEARCH**

NEWPORT AERONAUTICAL

www.newportaero.com

TECHNICAL MANUALS*

Newport provides technical manuals for most American military & commercial aircraft; including: engines, accessories, components and support equipment.

We supply USAF TO's, Navy-NAVAIR's, Army-TM's, Army-DMWR's, flight manuals, maintenance manuals, overhaul/repair manuals, illustrated parts catalogs and IPB's to meet any technical data requirement.

Used for: overhaul and repair of accessories and components, spare part replacement information, vendor information, location and identification of repair parts, acceptance test procedures, and part number cross reference information.

ENGINEERING DRAWINGS*

We supply complete **non-proprietary** manufacturers engineering drawings and detailed drawings on American-made spare parts and components. To satisfy requirements for:

PMA • Contract Bidding

Manufacturing • Repairs • Inspection

We can supply you with the latest revisions, updates, and changes on **unclassified** engineering drawings currently used by the US military services.

SAME DAY AVAILABILITY VIA ELECTRONIC DOWNLOAD



NEWPORT AERONAUTICAL



With over 40 years experience, Newport Aeronautical Sales is the largest aircraft technical data supplier in the US. We supply technical manuals and engineering drawings for most American-made commercial and military aircraft. We specialize in aircraft from the early 1940's to the present. In fact, we are the only company that truly specializes in technical manuals and engineering drawings on a full-time basis. We have the most complete library of technical manuals and engineering drawings available anywhere. With over 500,000 technical manuals, 1,000,000 engineering drawings and our vast network of suppliers, Newport can fulfill your technical data needs. Our knowledgeable and experienced staff will help to satisfy your requirements, without delay. No matter whether you need technical data for contract bidding, quoting the repair or inspection, we can help you get the information you need right away.

We look forward to serving you.



Sincerely,
George M. Posey, III
President

1542 Monrovia Avenue | Newport Beach, California 92663-2807
949.574.4100 | Fax 949.574.4106
www.newportaero.com | info@newportaero.com

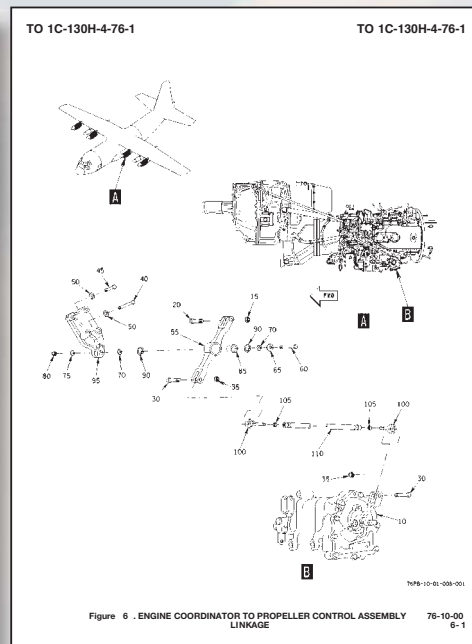
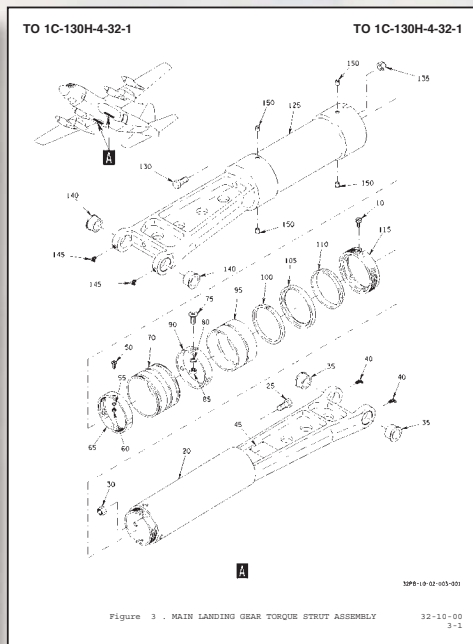

www.newportaero.com

TO 1C-130H-4-32-1		TO 1C-130H-4-32-1			
FIG. SYDN	PART NUMBER	CAGE	2 3 4 5 6 7	DESCRIPTION	USABLE ON CODE ASSY
3	- 5	388064-1	98897	MAIN LANDING GEAR TORQUE STRUT ASSEMBLY (SEE T.O. 401-49-1) (PARTS KIT AVAILABLE) (WHEN EXHAUSTED USE 388064-1) (SEE REFERENCED FIGURES FOR PARTS KIT) (SEE FIG. 1 FOR MAJ)	A REF
- 5	388064-3	98897	98897	STREET ASST, TORQUE, MAIN LANDING GEAR (SEE T.O. 401-49-1) (PARTS KIT AVAILABLE) (PREPARED GRADE IN LIEU OF 388064-1) (SEE REFERENCED FIGURES FOR PARTS KIT) (SEE FIG. 1 FOR MAJ)	C REF
10	HA1101-HH	88044	98897	STREET ASST, TORQUE, MAIN LANDING GEAR (SEE T.O. 401-49-1) (PARTS KIT AVAILABLE) (PREPARED GRADE IN LIEU OF 388064-1) (SEE REFERENCED FIGURES FOR PARTS KIT) (SEE FIG. 1 FOR MAJ)	C 1
- 15	388066-1	98897	98897	STREET ASST, TORQUE, MAIN LANDING GEAR (SEE T.O. 401-49-1) (PARTS KIT AVAILABLE) (PREPARED GRADE IN LIEU OF 388064-1) (SEE REFERENCED FIGURES FOR PARTS KIT) (SEE FIG. 1 FOR MAJ)	C 1
- 15	388066-7	98897	98897	STREET ASST, TORQUE, MAIN LANDING GEAR (SEE T.O. 401-49-1) (PARTS KIT AVAILABLE) (PREPARED GRADE IN LIEU OF 388064-1) (SEE REFERENCED FIGURES FOR PARTS KIT) (SEE FIG. 1 FOR MAJ)	C 1
20	388066-5	98897	98897	STREET ASST, TORQUE, MAIN LANDING GEAR (SEE T.O. 401-49-1) (PARTS KIT AVAILABLE) (PREPARED GRADE IN LIEU OF 388064-1) (SEE REFERENCED FIGURES FOR PARTS KIT) (SEE FIG. 1 FOR MAJ)	C 1
25	HA2025-3D	80205	98897	STREET ASST, TORQUE, MAIN LANDING GEAR (SEE T.O. 401-49-1) (PARTS KIT AVAILABLE) (PREPARED GRADE IN LIEU OF 388064-1) (SEE REFERENCED FIGURES FOR PARTS KIT) (SEE FIG. 1 FOR MAJ)	C 1
30	HA2104-5	96006	98897	STREET ASST, TORQUE, MAIN LANDING GEAR (SEE T.O. 401-49-1) (PARTS KIT AVAILABLE) (PREPARED GRADE IN LIEU OF 388064-1) (SEE REFERENCED FIGURES FOR PARTS KIT) (SEE FIG. 1 FOR MAJ)	C 1
35	338416	96006	98897	STREET ASST, TORQUE, MAIN LANDING GEAR (SEE T.O. 401-49-1) (PARTS KIT AVAILABLE) (PREPARED GRADE IN LIEU OF 388064-1) (SEE REFERENCED FIGURES FOR PARTS KIT) (SEE FIG. 1 FOR MAJ)	C 1
40	HA2101-4	96006	98897	STREET ASST, TORQUE, MAIN LANDING GEAR (SEE T.O. 401-49-1) (PARTS KIT AVAILABLE) (PREPARED GRADE IN LIEU OF 388064-1) (SEE REFERENCED FIGURES FOR PARTS KIT) (SEE FIG. 1 FOR MAJ)	C 1
45	HA2725-2	96006	98897	STREET ASST, TORQUE, MAIN LANDING GEAR (SEE T.O. 401-49-1) (PARTS KIT AVAILABLE) (PREPARED GRADE IN LIEU OF 388064-1) (SEE REFERENCED FIGURES FOR PARTS KIT) (SEE FIG. 1 FOR MAJ)	C 1
50	HA2621-1-5	80205	98897	STREET ASST, TORQUE, MAIN LANDING GEAR (SEE T.O. 401-49-1) (PARTS KIT AVAILABLE) (PREPARED GRADE IN LIEU OF 388064-1) (SEE REFERENCED FIGURES FOR PARTS KIT) (SEE FIG. 1 FOR MAJ)	C 1
55	HA21400063H	88044	98897	STREET ASST, TORQUE, MAIN LANDING GEAR (SEE T.O. 401-49-1) (PARTS KIT AVAILABLE) (PREPARED GRADE IN LIEU OF 388064-1) (SEE REFERENCED FIGURES FOR PARTS KIT) (SEE FIG. 1 FOR MAJ)	C 1
60	HA2142-3	96006	98897	STREET ASST, TORQUE, MAIN LANDING GEAR (SEE T.O. 401-49-1) (PARTS KIT AVAILABLE) (PREPARED GRADE IN LIEU OF 388064-1) (SEE REFERENCED FIGURES FOR PARTS KIT) (SEE FIG. 1 FOR MAJ)	C 1
65	338411	98897	98897	STREET ASST, TORQUE, MAIN LANDING GEAR (SEE T.O. 401-49-1) (PARTS KIT AVAILABLE) (PREPARED GRADE IN LIEU OF 388064-1) (SEE REFERENCED FIGURES FOR PARTS KIT) (SEE FIG. 1 FOR MAJ)	C 1
70	338418	98897	98897	STREET ASST, TORQUE, MAIN LANDING GEAR (SEE T.O. 401-49-1) (PARTS KIT AVAILABLE) (PREPARED GRADE IN LIEU OF 388064-1) (SEE REFERENCED FIGURES FOR PARTS KIT) (SEE FIG. 1 FOR MAJ)	C 1
75	HA217-5-3	80205	98897	STREET ASST, TORQUE, MAIN LANDING GEAR (SEE T.O. 401-49-1) (PARTS KIT AVAILABLE) (PREPARED GRADE IN LIEU OF 388064-1) (SEE REFERENCED FIGURES FOR PARTS KIT) (SEE FIG. 1 FOR MAJ)	C 1
80	HA217-5-7	80205	98897	STREET ASST, TORQUE, MAIN LANDING GEAR (SEE T.O. 401-49-1) (PARTS KIT AVAILABLE) (PREPARED GRADE IN LIEU OF 388064-1) (SEE REFERENCED FIGURES FOR PARTS KIT) (SEE FIG. 1 FOR MAJ)	C 1
80	HA11400063H	88044	98897	STREET ASST, TORQUE, MAIN LANDING GEAR (SEE T.O. 401-49-1) (PARTS KIT AVAILABLE) (PREPARED GRADE IN LIEU OF 388064-1) (SEE REFERENCED FIGURES FOR PARTS KIT) (SEE FIG. 1 FOR MAJ)	C 1
80	HA2142-5	96006	98897	STREET ASST, TORQUE, MAIN LANDING GEAR (SEE T.O. 401-49-1) (PARTS KIT AVAILABLE) (PREPARED GRADE IN LIEU OF 388064-1) (SEE REFERENCED FIGURES FOR PARTS KIT) (SEE FIG. 1 FOR MAJ)	C 1
90	338412	98897	98897	STREET ASST, TORQUE, MAIN LANDING GEAR (SEE T.O. 401-49-1) (PARTS KIT AVAILABLE) (PREPARED GRADE IN LIEU OF 388064-1) (SEE REFERENCED FIGURES FOR PARTS KIT) (SEE FIG. 1 FOR MAJ)	C 1
90	338413	98897	98897	STREET ASST, TORQUE, MAIN LANDING GEAR (SEE T.O. 401-49-1) (PARTS KIT AVAILABLE) (PREPARED GRADE IN LIEU OF 388064-1) (SEE REFERENCED FIGURES FOR PARTS KIT) (SEE FIG. 1 FOR MAJ)	C 1
100	HA2892-1	96006	98897	STREET ASST, TORQUE, MAIN LANDING GEAR (SEE T.O. 401-49-1) (PARTS KIT AVAILABLE) (PREPARED GRADE IN LIEU OF 388064-1) (SEE REFERENCED FIGURES FOR PARTS KIT) (SEE FIG. 1 FOR MAJ)	C 1
100	338415	98897	98897	STREET ASST, TORQUE, MAIN LANDING GEAR (SEE T.O. 401-49-1) (PARTS KIT AVAILABLE) (PREPARED GRADE IN LIEU OF 388064-1) (SEE REFERENCED FIGURES FOR PARTS KIT) (SEE FIG. 1 FOR MAJ)	C 1
110	HA217002-41	96006	98897	STREET ASST, TORQUE, MAIN LANDING GEAR (SEE T.O. 401-49-1) (PARTS KIT AVAILABLE) (PREPARED GRADE IN LIEU OF 388064-1) (SEE REFERENCED FIGURES FOR PARTS KIT) (SEE FIG. 1 FOR MAJ)	C 1
115	338414	98897	98897	STREET ASST, TORQUE, MAIN LANDING GEAR (SEE T.O. 401-49-1) (PARTS KIT AVAILABLE) (PREPARED GRADE IN LIEU OF 388064-1) (SEE REFERENCED FIGURES FOR PARTS KIT) (SEE FIG. 1 FOR MAJ)	C 1
- 120	338414-3	98897	98897	STREET ASST, TORQUE, MAIN LANDING GEAR (SEE T.O. 401-49-1) (PARTS KIT AVAILABLE) (PREPARED GRADE IN LIEU OF 388064-1) (SEE REFERENCED FIGURES FOR PARTS KIT) (SEE FIG. 1 FOR MAJ)	C 1
- 120	388065-1	98897	98897	STREET ASST, TORQUE, MAIN LANDING GEAR (SEE T.O. 401-49-1) (PARTS KIT AVAILABLE) (PREPARED GRADE IN LIEU OF 388064-1) (SEE REFERENCED FIGURES FOR PARTS KIT) (SEE FIG. 1 FOR MAJ)	C 1
- 120	388065-7	98897	98897	STREET ASST, TORQUE, MAIN LANDING GEAR (SEE T.O. 401-49-1) (PARTS KIT AVAILABLE) (PREPARED GRADE IN LIEU OF 388064-1) (SEE REFERENCED FIGURES FOR PARTS KIT) (SEE FIG. 1 FOR MAJ)	C 1
125	388065-3	98897	98897	STREET ASST, TORQUE, MAIN LANDING GEAR (SEE T.O. 401-49-1) (PARTS KIT AVAILABLE) (PREPARED GRADE IN LIEU OF 388064-1) (SEE REFERENCED FIGURES FOR PARTS KIT) (SEE FIG. 1 FOR MAJ)	C 1
125	388065-5	98897	98897	STREET ASST, TORQUE, MAIN LANDING GEAR (SEE T.O. 401-49-1) (PARTS KIT AVAILABLE) (PREPARED GRADE IN LIEU OF 388064-1) (SEE REFERENCED FIGURES FOR PARTS KIT) (SEE FIG. 1 FOR MAJ)	C 1
130	HA2025-3D	80205	98897	STREET ASST, TORQUE, MAIN LANDING GEAR (SEE T.O. 401-49-1) (PARTS KIT AVAILABLE) (PREPARED GRADE IN LIEU OF 388064-1) (SEE REFERENCED FIGURES FOR PARTS KIT) (SEE FIG. 1 FOR MAJ)	C 1
135	HA2104-5	96006	98897	STREET ASST, TORQUE, MAIN LANDING GEAR (SEE T.O. 401-49-1) (PARTS KIT AVAILABLE) (PREPARED GRADE IN LIEU OF 388064-1) (SEE REFERENCED FIGURES FOR PARTS KIT) (SEE FIG. 1 FOR MAJ)	C 1
140	338416	96006	98897	STREET ASST, TORQUE, MAIN LANDING GEAR (SEE T.O. 401-49-1) (PARTS KIT AVAILABLE) (PREPARED GRADE IN LIEU OF 388064-1) (SEE REFERENCED FIGURES FOR PARTS KIT) (SEE FIG. 1 FOR MAJ)	C 1
145	HA2101-4	96006	98897	STREET ASST, TORQUE, MAIN LANDING GEAR (SEE T.O. 401-49-1) (PARTS KIT AVAILABLE) (PREPARED GRADE IN LIEU OF 388064-1) (SEE REFERENCED FIGURES FOR PARTS KIT) (SEE FIG. 1 FOR MAJ)	C 1
150	HA2016-1A	80205	98897	STREET ASST, TORQUE, MAIN LANDING GEAR (SEE T.O. 401-49-1) (PARTS KIT AVAILABLE) (PREPARED GRADE IN LIEU OF 388064-1) (SEE REFERENCED FIGURES FOR PARTS KIT) (SEE FIG. 1 FOR MAJ)	C 1
- 155	HA2027-2	98897	98897	STREET ASST, TORQUE, MAIN LANDING GEAR (SEE T.O. 401-49-1) (PARTS KIT AVAILABLE) (PREPARED GRADE IN LIEU OF 388064-1) (SEE REFERENCED FIGURES FOR PARTS KIT) (SEE FIG. 1 FOR MAJ)	C 1
- 160	332822-1	98897	98897	STREET ASST, TORQUE, MAIN LANDING GEAR (SEE T.O. 401-49-1) (PARTS KIT AVAILABLE) (PREPARED GRADE IN LIEU OF 388064-1) (SEE REFERENCED FIGURES FOR PARTS KIT) (SEE FIG. 1 FOR MAJ)	D REF
- 160	334291-1	98897	98897	STREET ASST, TORQUE, MAIN LANDING GEAR (SEE T.O. 401-49-1) (PARTS KIT AVAILABLE) (PREPARED GRADE IN LIEU OF 388064-1) (SEE REFERENCED FIGURES FOR PARTS KIT) (SEE FIG. 1 FOR MAJ)	B REF



CMM'S, IPC'S, VENDOR MANUALS AND DRAWINGS AVAILABLE

Below is a list of subjects for which technical manuals, engineering drawings and specifications are available.

AIRCRAFT military and commercial

Attack, Cargo, Corporate, Fighter, Helicopter, Passenger, Trainer, Transport, Utility, and others. See back page for list of aircraft.

VEHICLES

Tanks, Trucks & Components

Ambulances, Armored vehicles, Axles, Brakes, Cranes, Jeeps, Motors, Test equipment, Tractors, Transporters, and others.

ENGINES, COMPONENTS AND RELATED EQUIPMENT

Afterburner systems, Auxiliary power Afterburner systems, Auxiliary power units, Blades, Exhaust assemblies, Helicopter Rotors, Ignition systems, Jet/turbine engines, Support equipment, and others.



AIRBORNE ELECTRONIC EQUIPMENT AND COMPONENTS

Autopilot systems, Communications systems, Display units, Navigation equipment, Radar, and others.

FUEL SYSTEMS AND COMPONENTS

Fuel control, Valves, Fuel handling equipment, Fuel pumps, Fuel tanks, Pods, Propellants, Refueling systems, Support equipment, and others.

HYDRAULIC SYSTEMS AND COMPONENTS

Accumulators, Actuators, Cleaning and purging equipment, Control systems, Filters, Hoses, Kits, Pumps, Servomechanisms, Valves, Support equipment, and others.



LANDING GEAR SYSTEMS AND COMPONENTS

Axles, Bearings, Brakes, Ground handling and support equipment, Jacks, Mechanisms, Servos, Struts, Tires, Tubes, Wheels, and others.

INSTRUMENTS AND RELATED SYSTEMS

Altimeters, Amplifiers, Attenuators, Calibration equipment, Circuit assemblies, Clocks, Compasses, Data display sets, Gyroscopes, Indicators, Meters, Relays, Switches, and others.

ELECTRICAL SYSTEMS AND EQUIPMENT

Automatic test equipment, Calibration and checkout equipment, Chargers, Converters, Generators, Lighting equipment, Power supplies, and others.



PROPELLERS AND COMPONENTS

Actuators, Alignment equipment, Balancers, Bearings, Bearings, Blades, Control assemblies, Gears, Governors, Ground handling equipment, Hoists, Servos, Special tools, and others.

NEWPORT AERONAUTICAL



NEWPORT AERONAUTICAL

AIRCRAFT APPLICATION LIST

Listed below are many of the aircraft and engines we supply manuals and drawings on.

Please call us if you do not see the model you need information about.

Aircraft by model number and manufacturer

35	Lear Jet	C-141	Lockheed	KC-130	Lockheed
36	Lear Jet	CF-5	Northrop	KC-135	Boeing
340	SAAB	CH-3	Sikorsky	L-20	Cessna
369	Hughes	CH-46	Boeing/Vertol	L-100	Lockheed
500	McDonnell Douglas	CH-47	Boeing/Vertol	L-188	Lockheed
707	Various	CH-53	Sikorsky	L-382	Lockheed
727	Various	CH-54	Sikorsky	L-1011	Lockheed
737	Various	CRJ-100/200	Bombardier	MD-11	McDonnell Douglas
747	Various	CRJ-700/900	Bombardier	MD-80	McDonnell Douglas
757	Various	DC-6	Douglas	MD-90	Douglas
767	Various	DC-8	Douglas	MH-53	Sikorsky
777	Various	DC-9	Douglas	MH-60	Sikorsky
A300	Various	DC-10	Douglas	O-2	Cessna
A310	Various	DHC-6	De Havilland	OV-1	Grumman
A320	Various	DHC-7	De Havilland	OV-10	North American
A330	Various	DHC-8	De Havilland	P3	Lockheed
A340	Various	ERJ-135	Embraer	P-51	North American
A-4	Douglas	ERJ-140/145	Embraer	S-2	Grumman
A-6	Grumman	ERJ-170/175	Embraer	S-3A	Lockheed
A-7	LTV	ERJ-190/195	Embraer	S-61	Sikorsky
A-10	Fairchild	E-2	Grumman	S-64	Sikorsky
A-37	Cessna	E-3A	Boeing	S-70	Sikorsky
AH-64	McDonnell Douglas	F-4	McDonnell Douglas	SA-16	Grumman
AV-8B	McDonnell Douglas	F-5	Northrop	SH-3	Sikorsky
B-52	Boeing	F-14	Grumman	SH-60	Sikorsky
B-200	Beechcraft	F-15	Boeing	T-2	North American
B-1900	Beechcraft	F-16	Lockheed	T-6	North American
CL-600	Canadian Reg. Jet	F-18	Boeing	T-28	North American
C-2	Grumman	F-28	Fokker/Fairchild	T-34	Beechcraft
C-5	Lockheed	F-111	General Dynamics	T-37	Cessna
C-7	De Havilland	H-3	Sikorsky	T-38	North American
C-17	McDonnell Douglas	H-60	Sikorsky	T-44	Beechcraft
C-47	Douglas	HH-53	Sikorsky	T-45	McDonnell Douglas
C-118	Douglas	HH-60	Sikorsky	T-47	Cessna
C-119	Fairchild	HH-65	Eurocopter	U-6	De Havilland
C-130	Lockheed	HU-16	Grumman	U-21	Beechcraft
C-140	Lockheed	KC-10	McDonnell Douglas	UH-60	Sikorsky



NEWPORT AERONAUTICAL

1542 Monrovia Avenue

Newport Beach, California 92663-2807

949.574.4100 | Fax 949.574.4106

www.newportaero.com | info@newportaero.com

All technical data is published by
Original Equipment Manufacturers
and U.S. Governmental Agencies

Some sales are subject to U.S. Government approval
and export controlled (in accordance with DOD 5230.25)

No classified or proprietary data is available

www.newportaero.com